

March 10, 2020

Swift Creek Current

Swift Creek Elementary School, 5601 Tryon Road, Raleigh, NC 27606

<http://swiftcreekes.wcpss.net>

919-233-4320

From the Principal's Desk

Hello, Swift Creek families! As we observed Read Across America last week, I was reminded of the huge impact the local community has on our school. Swift Creek students benefit every day from the strong partnerships we have with organizations and businesses around us. If you are part of one of those partnerships, we thank you and look forward to the next opportunity we have to work together. If you are part of an organization that is not connected to Swift Creek, let's talk about how we can change that. We would love to establish more ties with our neighbors to create an even stronger community.

Speaking of community, International Night is one of my favorite events of the year at Swift Creek and it is coming up on March 26. We are looking forward to celebrating the many wonderful cultures represented by the families in our school. The theme for this year, "This Is How We Do It" is all about the many different ways that people all around the world perform daily tasks. Hopefully, your child will share with others aspects of your family's culture.

As you hear news about the COVID-19 virus impacting our area, please know that we are taking necessary precautions as directed by district health officials. We are teaching students to cough into their elbows, providing time for frequent and thorough handwashing, and encouraging students and staff to stay home if they are sick. At the same time, if your child is not sick, then please ensure that they continue to come to school on time and ready to learn. These last few months of school are vital to prepare them for the next grade.

Thank you for everything you do to make Swift Creek shine!

Darrell Propst, Principal
Swift Creek Elementary School



Family Heart Hop is THIS FRIDAY!

The third time is the charm. We will finally have the Family Heart Hop on Friday, March 13.

To help us get an accurate count, please RSVP online at <http://tinyurl.com/scesDance3>

In This Issue

P2 Corner

Don't Underestimate the Power of Hand Washing

Order Your Yearbook

PTA Officer Nominations

Sign Up for Camp Invention

Watch DOGS: We NEED You!

Spring Book Fair

Art Room Needs

Recycling Updates

Your March and April Calendars

P2 Corner:

Mar 8-14
Social Intelligence



What Does Social Intelligence Mean?

You are aware of other people's thoughts and feelings. You understand why they do things.

Why Does It Matter?

Social Intelligence helps individuals build relationships.

On a group level, social intelligence is what allows us to function as humans. We are social beings and rely on each other's cooperation. By understanding ourselves and other people, we can find ways to collaborate for mutual benefit.

Mar 15-21
Love of Learning



What Does Love of Learning Mean?

You master new topics on your own or in school.

Why Does It Matter?

Developing a love of learning is highly beneficial for an individual. It means that they are intrinsically motivated to deepen their existing skills and abilities, or learn something completely new.

On a group level, love of learning is crucial. The best leaders have an insatiable desire to learn. And it's only by learning and experimenting that we continue to grow.

Mar 25-29
Fairness



What Does Fairness Mean?

You believe that all people have value. You approach situations with an unbiased mindset and treat everyone with respect.

Why Does It Matter?

For individuals, cultivating the character strength of fairness is correlated with highly desirable developmental outcomes. It helps people to become trustworthy friends, responsible citizens, and generally moral people. Fairness is also essential for the good of the group.

Apr 1-5
Humor



What Does Humor Mean?

You like to laugh and bring smiles to other people.

Why Does It Matter?

For individuals, humor has important health benefits, both mental and physical. Humor stretches the mind to look at things from different perspectives, keeping people mentally agile and alert.

Humor plays an important role in helping groups of people rise above difficult circumstances and boost morale. It removes us from our present difficulties by easing tension and making life more fun.

Advocacy Alert:

Don't Underestimate the Power of Washing Your Hands!

Good hand washing is the first line of defense against the spread of many illnesses — from the common cold to more serious infections. Teach proper hand washing to your children and wash your hands together often to support the good habit. Wash your hands before eating, cooking, after using the bathroom, cleaning, touching animals, being around anyone who is sick, blowing your nose, coughing or sneezing or after being at a playground, museum or public place.

Best Practices

1. Wet your hands with clean, running water (warm or cold).
2. Use soap and lather up for about 20 seconds. Sing the ABC's or HAPPY BIRTHDAY TWICE!!
3. Make sure you get in-between your fingers, on the backs of hands, and under the nails where germs like to hang out. And don't forget the wrists!
4. Rinse and dry well with a clean towel.

Update from Wake County Schools about COVID-19

For more information about Wake County School's response to the coronavirus, see <https://www.wcpss.net/coronavirus>



Order Your Yearbook: Deadline is March 16

Time is running out for you to order your yearbook for this school year! Yearbooks are \$13.15. They can be ordered online at <http://tinyurl.com/scesYearbook> or using the paper order form at <http://swiftcreekeswcpssnetptahtml.weebly.com/yearbook.html>.

Seeking PTA Officer Nominations

Do you know someone who would be AWESOME as a PTA officer or committee chair?

We are currently accepting nominations for next year. Elections will be held at the May PTA meeting. If you have suggestions, please contact Sarah Lewis at sarahlynnlewis@gmail.com.

Watch DOGS: Half-Day Opportunities Now Available

The school year is flying along and to help get more gentlemen involved in the program we are introducing **half-day sign-up opportunities**. Your day will either start at the beginning of school and end after your student's lunch, or begin with your student's lunch and end after school.

There is still time to make an impact at Swift Creek and volunteer to be a Watch D.O.G. Get your picture added to our Hall of Fame! It is a great way to contribute to your SCES community. It's also an opportunity to make a memory with your student during recess, lunch, or while working on fractions!

Sign Up for Camp Invention This Summer

Camp Invention® is a nationally acclaimed summer program where STEM concepts come to life. Led by local teachers, this program has tapped into kids' natural curiosity since 1990, giving them the opportunity to become innovators through teamwork and immersive, hands-on creative problem-solving.

This summer, campers will explore flight with rockets and robots, learn the value of their creativity through hands-on activities, collaborate to help protect the Earth and design a sports complex!

At the end of the week, they will bring home their very own personalized robot! If you have questions, contact Camp Director, Mrs. Monica Coles at mcoles@wcpss.net. You can also contact Camp Parent, Marie Dexter at mariecddexter@gmail.com.

Register for this year's summer camp at <https://tinyurl.com/scesCamp2020>

Through March 31, use promo code **CP25CAMP** to **SAVE \$25**.

Time is Running Out!

It will be June before you know it. Time is running out for you to participate in this year's program!

Thanks so much to those who already volunteered! WE NEED MORE WATCH DOGS for the rest of the school year!

Email Sam Allen with any questions or to sign-up for a day (or half-day either beginning or ending with your Cougar's lunch) at sfallenprc@gmail.com or sfallen@ncsu.edu

Or sign up at <https://tinyurl.com/scesDOGS1920>. Sam will add you to the school's calendar so they are ready with your schedule and picture with your Cougar(s).



Dads of Great Students



Camp Invention®

Join Team Swift Creek at the Garden Gallop 5k Run/Walk on Saturday, March 21 9:00am

You may not know but the Interfaith Food Shuttle has been instrumental in the creating and maintenance of our Swift Creek Garden. This work is possible through the Interfaith Food Shuttle's Urban Agriculture Education Initiatives. The 5K directly benefits this program and so US!

We would love for you to join our team. Sign up today at <https://fsseries.com/event/garden-gallop-5k/>

At the event, look for the BIG Swift Creek sign so we can run/walk together!

We Need You at Our Spring Landscaping Day!

Spring is just around the corner! Please join us on Sat April 18th as we continue to spruce up the school grounds. If you love working outdoors, we need YOU! Light snacks and water will be provided. HOPE TO SEE YOU THERE!

Don't forget the yard tools...rakes, hoes, clippers, wheelbarrow, etc.

Sign up at <http://tinyurl.com/scesApr18>

If you have questions, contact landscaping chair, Tracey McCloud at mccloud1228@yahoo.com.



Do you have a chain saw or a truck?

Work is being done to remove the Junipers at the front of the school. We are in need of a chain saw to cut all stumps to the ground.

Also, if you have a truck, we could use your help to haul away the yard debris. contact landscaping chair, Tracey McCloud at mccloud1228@yahoo.com.

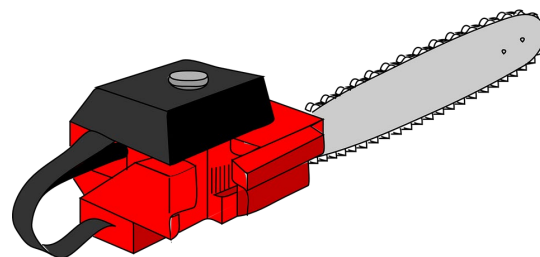

Thank You for Donating to the Teacher Cart!

Hospitality Chair, Sarah Wohldmann, made her rounds with the Teacher Cart on Friday, Feb 28. The teachers loved picking special snacks and classroom supplies! Thank you to everyone who donated fruit, wipes, books, water, treasure box supplies, and more to the February cart. Be on the lookout for a sign up for the March cart!



Bedford Falls Book Fair March 23 - 27:

Explore the World Through Books!

For our spring book fair, we are hosting Bedford Falls. (You might remember them from last spring). This company provides a wide selection of titles that aren't available at other book fairs.

Preview and Shopping Days

During this week, students will have an opportunity to preview the fair with their class and create wish lists. These wish lists will come home for you to review. Then later in the week, each class has an assigned shopping day. Students should bring money for the book fair on their shopping days (**not** before).

The book fair will also be open in the morning starting around 9 for parents who wish to stop by. The fair closes at noon on Friday, March 27.

Every Child at the Creek Will Receive a Free Book

In addition, through the help of PTA funds and Scholastic dollars, each child at Swift Creek will receive a free book at the fair. Mrs. Wils will help students select their book on the class shopping day.

Family Night, Thursday March 26 5:30-7:45

Family Night at the Book Fair is on Thursday, March 26 from 5:30-7:45 (in conjunction with International Night). This is a great opportunity for everyone to visit the fair!

Volunteers Needed!

Because this is such a big event, we need lots of volunteers to help throughout the week! Sign up at <https://tinyurl.com/scesBooks20>.

Donations for Quarter Books

We want every child to have the experience of purchasing a book. Do you have gently used books at home that you would like to donate to our 25 cent box? If so, please contact Kristen Sherman about how you can donate these books for our Quarter Book bin.

Want more information? Contact Book Fair committee chairs, Kristen Sherman at kmartaz73@gmail.com, and Heather Chapman at wilsonreadingteacher@gmail.com.



5th Grade Artists Need These Items:

- small solid boxes--like jewelry, cigar, candy, cell phone, ipad, matchboxes
- embroidery thread
- tapestry needles
- glitter glue
- sequins
- liquid starch
- maps
- happy meal toys
- matchbox cars
- Barbie doll accessories
- stickers of all kinds
- broken jewelry/watches
- anything miniature
- coins
- buttons
- game pieces--like from Monopoly, Game of Life, Scrabble, Checkers, Chess etc.
- white cardstock
- Ziploc bags

Art News

The art room still needs these items:

- Paper tubes
- Cool whip containers with lid
- Wine corks
- Legos
- Wooden blocks
- Container tops
- Easy mac and cheese containers
- Yarn
- Wire twist ties
- Electrical wire

View Mrs. McIntyre's Amazon Wish List at <http://tinyurl.com/scesArtWishes>

Does your artist have a creation at home that they'd love to share? Send it in for the Art Challenge Wall (which is located outside Mrs. McIntyre's classroom).

Deadline for Single Subject Acceleration Requests

It's almost time for Single Subject Acceleration testing. Requests for testing must be turned in between March 23 and March 27. The testing window is April 20-April 30. The request form can be obtained from your child's teacher or you may email me at skrutsch@wcpss.net. For more information visit <https://www.wcpss.net/Page/3799> or contact me. There is more information on my website: <https://sites.google.com/wcpss.net/suzannakrutsch/home>. (You can also get to my site by going to the school's website, choosing students, and then choosing AIG.)

Join Our Family Buddy Program

Did you know that new families join our Swift Creek community throughout the year? We are looking for current families who might be interested in being part of our Buddy Program. When a new family arrives at the school, you will be paired with them to answer questions, keep the new family posted about school events, and make them feel welcome!

Be a Buddy!

If you are interested, contact Marie Dexter at mariecdexter@gmail.com or complete this form:

<http://tinyurl.com/scesBuddies>

. Thank you for making our community stronger!

Recycling Program Updates!

For questions about the recycling programs at Swift Creek, please contact Megan Holler at MeganAndrews81@gmail.com

Recycling programs at The Creek are in full swing! Here are our numbers to date (in pounds diverted from the landfill):

1. TerraCycle's squeezable snack pouches: 21 pounds
2. TerraCycle's foil lined snack wrappers: 20 pounds
3. NextTrex plastic film: 10.5 pounds
4. ColorCycle: 15 pounds (collected during the 2018-19 school year)



Classrooms have been given purple recycling bags for collecting pouches and snack wrappers during the day. These can then be transferred to the collection bins in the cafeteria when it's convenient for each class.

The NextTrex bin, for plastic film recycling, is located in the main hall, down from the front doors. Markers and highlighters for the ColorCycle program, can be turned into Mrs. McIntyre.

Please continue to send in items, for all of our programs, from home! (Caps on pouches, all else empty and dry, please.)



Again, a big thanks goes to Ms. Hunt and our after-school program team who collects all of the recyclables from the new blue recycling bins for the expanded Feed the Bin Program. This Wake County program allows our school to recycle bottles, tubs, jugs, and jars, metal cans, and paper, which closely mirrors our curbside recycling program. Ask your child about his/her new blue bin, today!

We are now in our 3rd week of composting our lunchroom trays! Our cafeteria team has been working hard to fit the trays into our two compost carts from CompostNow. Thank you to everyone for making this important program an immediate success!



Building on the composting momentum, please keep an eye out for compostable products coming soon to our PTA events.

March Madness and National Nutrition Month

Spring is right around the corner! March is National Nutrition Month. For this month's challenge, can you complete these tasks?

- PLAY 60 minutes every day. (You do have 30 min of recess and 45 minutes of PE once a week.)
- Eat 5 fruits and vegetables each day.
- Make time for a family walk, bike ride, hike, or outdoor/indoor activity one time a week.
- Help in the kitchen one time a week.
- Try a new recipe and write three sentences or draw a picture about it! Share it with Ms. Graves!

Kids Heart Challenge

Way to go Swifties!

We raised \$4900 in the Kids Heart Challenge. Ms.

Graves' goal was \$6000, so we were very close! Thank you to everyone for participating!

Your March Calendar

- ❑ **Mar 8-14:** P2 Social Intelligence
- ❑ **March 9:** Teacher Work Day
- ❑ **March 10 6:30pm:** PTA meeting and drama performance
- ❑ **March 13**
 - March Madness Spirit Day! Come dressed in your college or sport's team favorite colors. The winning class will have a special visit from Mr. Propst. He will read a basketball themed book.
 - **5:30pm:** Family Heart Hop. Please RSVP at <http://tinyurl.com/scesDance3>
- ❑ **Mar 15-21: P2 Love of Learning**
- ❑ **March 20:** Clean Up the Garden day for K-2. Our kindergarteners, 1st graders, and 2nd graders will be cleaning out the garden beds today and getting them ready for the Spring Planting on April 17. Be sure to send your kiddo in clothes that can get dirty.
- ❑ **Mar 21 9:00am:** Garden Gallop 5K hosted by the Interfaith Food Shuttle. We'd love for you to join team Swift Creek. If interested, contact Marie Dexter at mariecddexter@gmail.com for more details.
- ❑ **Mar 22-28:** P2 Fairness
- ❑ **Mar 23-27:** Spring Book Fair from Bedford Falls. If you are interested in helping, contact Book Fair committee chairs, Kristen Sherman kmartaz73@gmail.com and Heather Chapman at wilsonreadingteacher@gmail.com.
- ❑ **March 26 5:30-7:30:** Family Night at the Book Fair and International Night "This Is How We Do It"
- ❑ **March 29-April 4:** P2 Humor

Your April Calendar

- ❑ **April 1-4:** P2 Humor
- ❑ **April 6-10:** Spring Break! No School.
- ❑ **April 12 – 18:** Identifying and appreciating the good in others
- ❑ **April 13:** Teacher Work Day. No School.
- ❑ **April 14-17:** Principal and Assistant Principal Appreciation Week!
- ❑ **April 17 5:30pm:** Family Game Night. If you are interested in helping plan this event, contact Marie Dexter at mariecddexter@gmail.com.
- ❑ **April 18 9:00-11:00:** Spring Grounds Clean Up Day
- ❑ **April 19-25:** P2 Appreciation of Beauty and Excellence
- ❑ **April 20 – 24:** Administrative Assistant Appreciation Week
- ❑ **April 29:** Celebration of Brilliance.

Autism Acceptance Spirit Week!

Swift Creek will be celebrating the diversity in our community by participating in our Second Autism Acceptance Spirit Week. We look forward to students and staff participating!!! Our spirit days are below:

Pokemon Monday: (3/30) Satoshi Tajiri, the creator of Pokemon, is autistic. He used his unique perspective to create the world of Pokemon. To celebrate his work, dress up as your favorite Pokemon character, or create your own.

Neurodiversity Tuesday: (3/31) To celebrate the beauty in the diverse spectrum of the human mind, wear rainbow and/or tie-dyed clothes to school!

What's YOUR Passion

Wednesday: (4/1) One characteristic of autism is to show incredibly focused passion for topics of interest. What are you passionate about? Dress up to show something you love!

Swift Creek Autism Acceptance Thursday (World Autism Awareness Day): (4/2) Wear blue to show our support, awareness, and appreciation for individuals on the Autism Spectrum!

Sensory Friendly Friday: (4/3) Autistic people often have a variety of sensory sensitivities. Dress up today in your most comfy clothes (including school-appropriate pjs), use as much natural light in your classroom instead of fluorescents, and/or wear sunglasses!